



BOEDEKER PLASTICS, INC.

Solutions for the Food & Beverage Industry

Engineering Plastic Shapes & Precision Machined & Molded Parts

Reduce Supply Chain Cost, Downtime & Enhance Food Safety

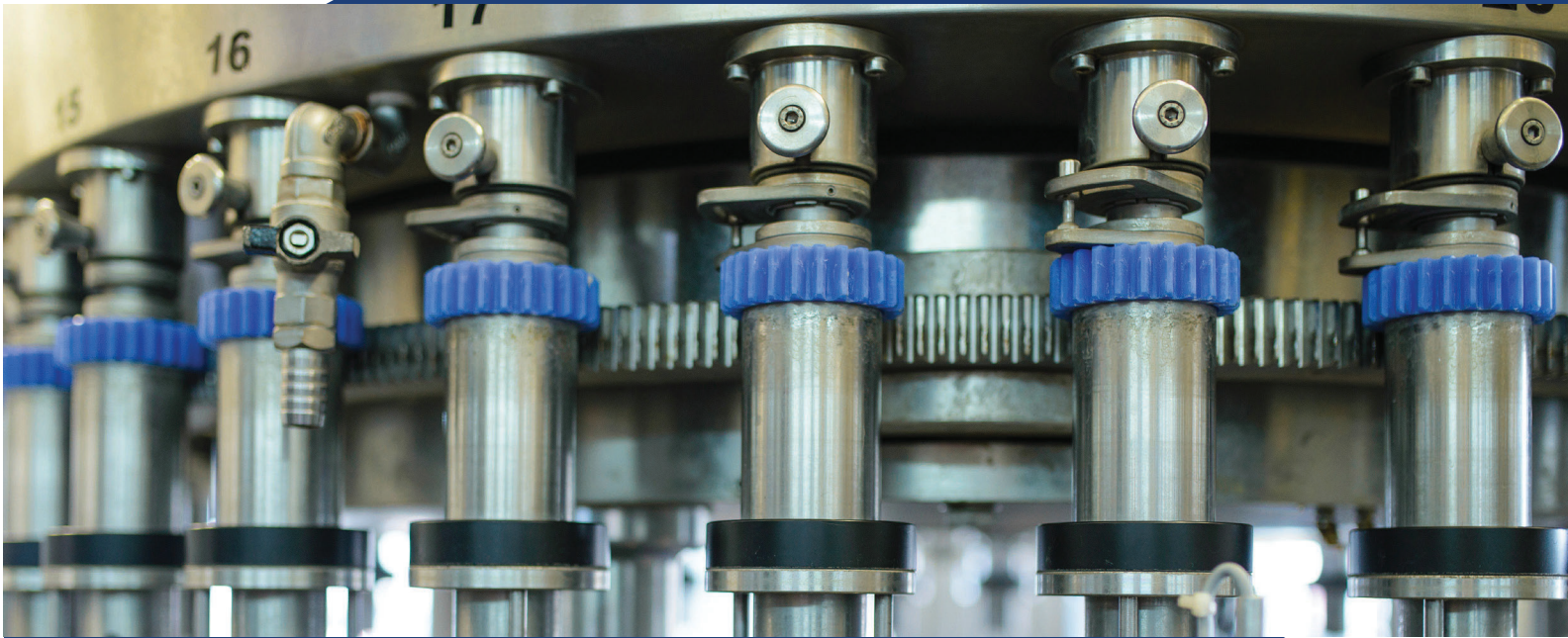

800.444.3485 | WWW.BOEDEKER.COM



BOEDEKER PLASTICS, INC.



Engineering Plastics & Composite Sheet, Rod & Tube



- American Owned & Operated
- 500+ Years Combined Plastics Experience
- Hard to Find Materials and Sizes
- FDA Compliant & Detectable Plastics
- 15+ Million Dollar Inventory
- Same Day Shipments & Cut to Size Service
- Entire Inventory is Coded for Full Traceability
- MFG. Certs. and C of C's Available Upon Request



Precision Machining, Molding & Technical Services

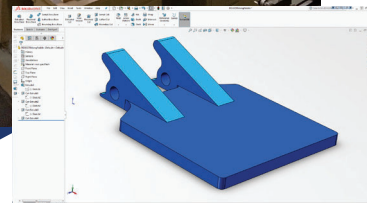

- 80+ CNC Machines
- Injection Molding for High Part Volumes
- JIT Part Supply | Reduce Inventory Costs
- Material Selection Services by Application
- Part Design Assistance
- Specializing in Plastic & Composite Only Machining
- ISO 9001 & 13485 Certified
- CAD Software | SOLIDWORKS & Pro/ENGINEER
- Metrology (CMMs, Vision Systems, and more)
- Metal to Plastic Conversion

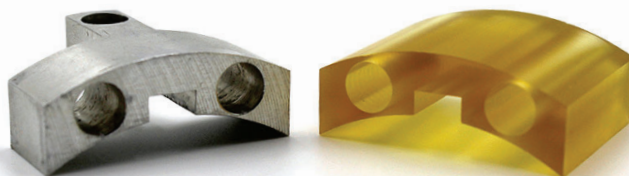

Contact us, we stand ready to assist | 800.444.3485 | RFQ@BOEDEKER.COM



Solutions for the Food & Beverage Industry Since 1984

We offer solutions for Engineering, Maintenance & Supply Chain personnel in all segments of the Food & Beverage Industry that solve challenging problems and supply demands with our materials, parts and services that reduce equipment downtime & enhance food safety. We offer a wide selection of FDA compliant and advanced materials for longer wear life, improved chemical resistance and lower friction along with materials that are Metal and X-Ray detectable for enhanced food safety.



Common Food Processing Applications

- Scraper Blades / Mixing Paddles
- CIP (Clean in Place) Components
- Filler Valve Pistons
- Bushings & Bearings
- Packaging Components
- Belt Scrapers
- Conveyor Wear Strip
- Corner Tracks
- Manifolds & Seals

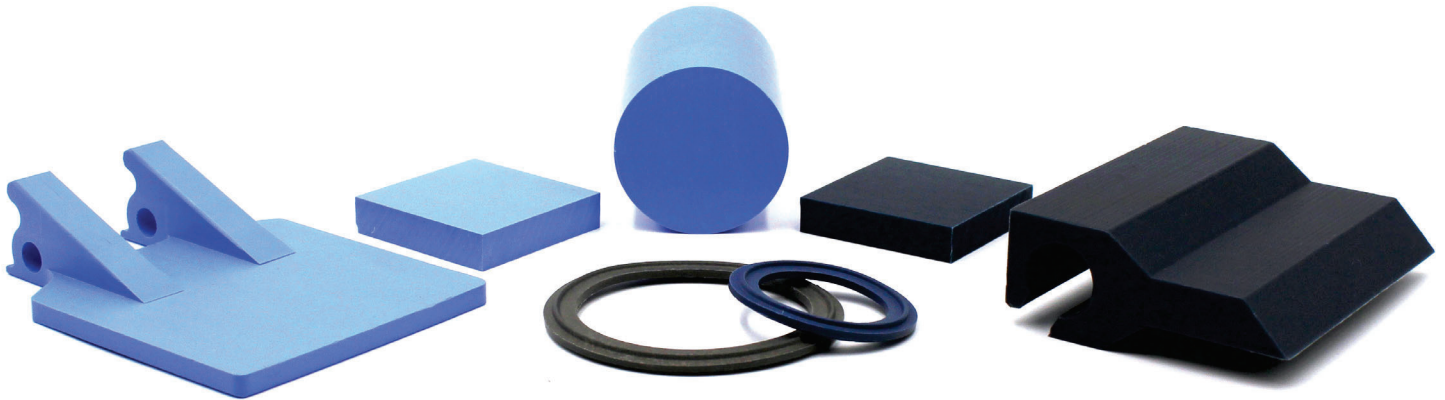

Common Beverage Processing Applications

- Gripper Lug Components
- Filler Equipment Components
- Capping Machine Components
- Bushings & Bearings
- Corner Tracks / Wear Strip
- Packaging Equipment Components
- Sprockets & Gears
- Star Wheels/ Screws
- Cam Followers





BOEDEKER PLASTICS, INC.

Invested in our personnel, facility, inventory, software and equipment to serve our customers with the highest levels of service and quality.

Headquartered in South Central TX with 100K+ square feet on a 21 acre campus



Fast Delivery | Same Day Shipping



Some of the materials we stock and machine

ABS (Acrylonitrile Butadiene Styrene)
Acetal Homopolymer (Polyoxymethylene)
Acetal Copolymer
Acetron GP ® Grades
Acrylic
CPVC (Chlorinated Polyvinyl Chloride)
Celazole ® PBI (Polybenzimidazole)
Celazole T-Series ® PBI-PEEK Blends
Ceramic, Machinable
CIP Composites™
Delrin ® (Acetal Homopolymer) Grades
Delrin ® AF
Duratron ® D, T & U Grades
Duravar ® UHMW
ECTFE (Ethylene-Chlorotrifluoroethylene)
Ertalyte ® PET-P (Polyethylene Teraphalate)
Ertalyte ® TX PET-P
ETFE (Ethylene-Tetrafluoroethylene)
FEP (Fluorinated Ethylene Propylene)
Fluorosint ® Grades
G-3, G-5, G-7, G-9, G-10, G-11, G-30
HDPE (High Density Polyethylene)
Halar ® ECTFE
Hydex 4101 ® PBT (Polybutylene Teraphalate Polyester)
Hydex 4101 ® UD Blue Ultra Detectable
Hydlar Z ® (Nylon with Kevlar ® Aramid Fiber)
Ketron ® 1000 PEEK
Ketron ® PEEK-CA30
Ketron ® HPV PEEK (Bearing Grade)
Kynar ® PVDF (Polyvinylidene Fluoride)
LDPE (Low Density Polyethylene)
Lexan ® PC (Polycarbonate)
LubX ® C & CV Low Friction UHMW
Macor ® MGC (Machinable Glass Ceramic)
Makrolon® PC (Polycarbonate)

Noryl ® PPO
Nylatron ® Grades
Nyloil ® Cast Oil Filled Nylon
Nylon Type 6 (Cast) Grades
Nylon Type 6/6 (Extruded) Grades
PAI (Polyamide Imide)
PBI (Polybenzimidazole)
PBT-Polyester (Hydex ® 4101)
PC-300™ / PC-350™ (Antistatic Coated Polycarbonate)
PCTFE (Polychlorotrifluoroethylene)
PEEK (Polyetheretherketone)
PEEK CA30 Carbon Filled
PEEK HT (Hi Temp)
PEEK-GF30 Glass Filled
PEI (Polyetherimide)
PETG
PET-Polyester
PFA (Perfluoroalkoxy)
PI (Polyimide)
PPO (Modified Polyphenylene Oxide)
PPS (Polyphenylene Sulfide) Filled & Unfilled Grades
PPSU (Polyphenylsulfone)
PTFE (Polytetrafluoroethylene) Unfilled
PVC (Polyvinyl Chloride)
PVDF (Polyvinylidene Fluoride)
Phenolic Laminates
Plavis ® PI Polyimide
Plexiglas ® Acrylic
Polycarbonate
Polyetheretherketone
Polyetherimide
Polyethylene (HDPE, LDPE, HMW, UHMW)
Polyimide (DuPont™ Vespel ®)
Polyketone (PK)

Polypropylene
Polystone ® G HDPE
Polystone ® M UHMW Grades
Polystone ® M MDT UHMW (FDA Metal Detectable)
Polystone ® M XDT UHMW (FDA X-Ray Detectable)
Polystone ® P Polypropylene
Polystone ® P MG (Heat Stabilized PP)
Polyurethane
Radel ® R PPSU
Rulon ® Grades
Ryton ® PPS
Sustamid ® 6G Cast Nylon
Sustamid ® 66 Extruded Nylon
SustaPEEK ® Grades
SustaPEEK ® XDT (FDA X-Ray Detectable)
Sustakon ® Polyketone
Sustarin ® Acetal Grades C, H
Sustarin ® C Acetal MDT (FDA Metal Detectable)
Sustarin ® C Acetal XDT (FDA X-Ray Detectable)
TECAFORM ® AU UHD Ultra Detectable
TECAPEEK ® Grades
TECAPEEK ® UD Blue Ultra Detectable
TECAPEI ® Grades
Techtron ® PPS Grades
Techtron ® HPV (bearing grade PPS)
Teflon ® DuPont™ PTFE
TIVAR ® Grades
Torlon ® PAI Grades
UHMW (Polyethylene)
Ultem™
Urethane
DuPont™ Vespel ®

Cut to Size Precision Cutting!



Enhanced Material Solutions
FDA Compliant Grades
Metal Detectable
X-Ray Detectable
Higher Performance
Enhanced Wear Life
Lower Friction
Higher Temperature
Chemical Resistance

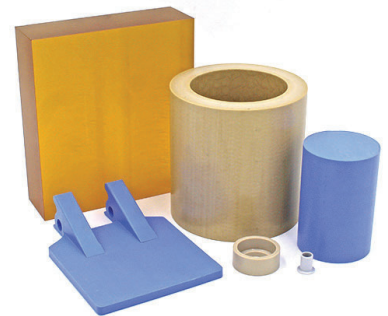

CONTACT / VISIT US [in](#) [f](#) [t](#) [YouTube](#)

904 WEST 6TH STREET, SHINER, TX 77984 | 800.444.3485 | WWW.BOEDEKER.COM | RFQ@BOEDEKER.COM